

Tube Fittings • UEU/UUT

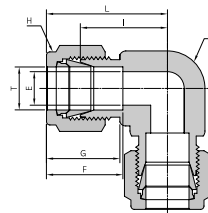

Union Elbow
UEU



Connects Fractional Tube

Part No.	Tube O.D. T		E Min	h		H		F	G	l	L
	in	mm		in	mm	in	mm				
20UEU	1-1/4	31.75	27	1-11/16	42.86	1-7/8	47.63	41.1	38.8	44.4	66.5
24UEU	1-1/2	38.10	34	2	50.80	2-1/4	57.15	50.0	45.2	50.8	77.9
32UEU	2	50.80	46	2-3/4	69.85	3	76.20	67.5	62.7	69.8	107.1

Connects Metric Tube

Part No.	Tube O.D. T(mm)	E Min	h		H		F	G	l	L
			in	mm	in	mm				
M28UEU	28.0	22	1-5/8	41.27	1-13/16	46.04	36.6	36.6	43.2	64.0
M30UEU	30.0	26	1-13/16	46.04	1-15/16	49.21	39.6	39.2	48.3	69.9
M32UEU	32.0	27	1-13/16	46.04	1-15/16	49.21	42.0	41.6	49.3	72.3
M38UEU	38.0	33	2-3/16	55.56	2-3/8	60.32	49.4	47.9	56.4	84.0



Union Tee
UUT

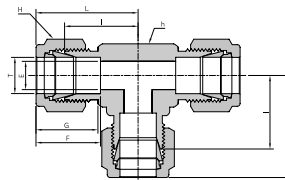

Connects Fractional Tube

Part No.	Tube O.D. T		E Min	h		H		F	G	l	L
	in	mm		in	mm	in	mm				
20UUT	1-1/4	31.75	27	1-11/16	42.86	1-7/8	47.63	41.1	38.8	44.4	66.5
24UUT	1-1/2	38.10	34	2	50.80	2-1/4	57.15	50.0	45.2	50.8	77.9
32UUT	2	50.80	46	2-3/4	69.85	3	76.20	67.5	62.7	69.8	107.1

Connects Metric Tube

Part No.	Tube O.D. T(mm)	E Min	h		H		F	G	l	L
			in	mm	in	mm				
M28UUT	28.0	22	1-5/8	41.27	1-13/16	46.04	36.6	36.6	43.2	64.0
M30UUT	30.0	26	1-13/16	46.04	1-15/16	49.21	39.6	39.2	48.3	69.9
M32UUT	32.0	27	1-13/16	46.04	1-15/16	49.21	42.0	41.6	49.3	72.3
M38UUT	38.0	33	2-3/16	55.56	2-3/8	60.32	49.4	47.9	56.4	84.0

Note : Dimensions are reference only, subject to change without prior notice. F,G and L are typical finger tight.