

# Tube Fittings • UFC/UU

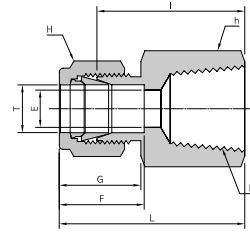

Female Connector  
**UFC**



## Connects Fractional Tube to Male NPT Thread

Part No.	Tube O.D. T		P (NPT)	E Min	h		H		F	G	l	L
	in	mm			in	mm	in	mm				
20UFC-20N	1-1/4	31.75	1-1/4	27	2-1/8	53.98	1-7/8	47.63	41.1	38.8	52.5	74.6
24UFC-24N	1-1/2	38.10	1-1/2	34	2-3/8	60.33	2-1/4	57.15	50.0	45.2	56.1	83.3
32UFC-32N	2	50.80	2.	46	2-7/8	73.03	3	76.20	67.5	62.7	64.2	101.6

Female ISO Tapered Threads are available for all fractional UFC. Add "R" as a suffix instead of "N".



Union  
**UU**

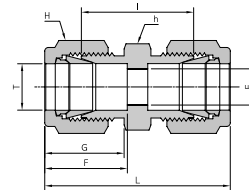

## Connects Fractional Tube

Part No.	Tube O.D. T		E Min	h		H		F	G	l	L
	in	mm		in	mm	in	mm				
20UU	1-1/4	31.75	27	1-3/4	44.44	1-7/8	47.63	41.1	38.8	48.0	92.2
24UU	1-1/2	38.10	34	2-1/8	53.97	2-1/4	57.15	50.0	45.2	53.6	107.9
32UU	2	50.80	46	2-3/4	69.85	3	76.20	67.5	62.7	74.6	149.3

## Connects Metric Tube

Part No.	Tube O.D. T(mm)	E Min	h		H		F	G	l	L
			in	mm	in	mm				
M28UU	28.0	22	1-5/8	41.27	1-13/16	46.04	36.6	36.6	43.4	85.0
M30UU	30.0	26	1-13/16	46.04	1-15/16	49.21	39.6	39.2	49.5	92.7
M32UU	32.0	28	1-13/16	46.04	1-15/16	49.21	42.0	41.6	51.3	97.3
M38UU	38.0	33	2-3/16	55.56	2-3/8	60.32	49.4	47.9	58.4	113.6

Note : Dimensions are reference only, subject to change without prior notice. F,G and L are typical finger tight.