

Tube Fittings • UMC/UME

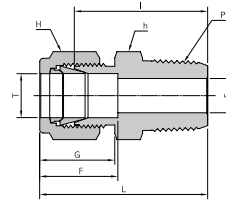

Male Connector
UMC



Connects Fractional Tube to Female NPT Thread

Part No.	Tube O.D. T		P (NPT)	E Min	h		H		F	G	l	L
	in	mm			in	mm	in	mm				
20UMC-16N	1-1/4	31.75	1	22	1-3/4	44.44	1-7/8	47.63	41.1	38.8	55.1	77.2
20UMC-20N	1-1/4	31.75	1-1/4	27	1-3/4	44.44	1-7/8	47.63	41.1	38.8	55.1	77.2
24UMC-24N	1-1/2	38.10	1-1/2	34	2-1/8	53.98	2-1/4	57.15	50.0	45.2	61.7	88.9
32UMC-32N	2	50.80	2	46	2-3/4	69.85	3	76.20	67.7	62.7	76.2	113.5

Male ISO Tapered Threads are available for all fractional UMC. Add "R" as a suffix instead of "N".

Note : Dimensions are reference only, subject to change without prior notice. F,G and L are typical finger tight.

Connects Metric Tube to ISO Tapered Thread

Part No.	Tube O.D. T(mm)	P (PT)	E Min	h	H	F	G	l	L
M28UMC-16R	28.0	1	22.0	41.27	46.04	36.6	36.6	51.6	72.4
M28UMC-20R	28.0	1-1/4	22.0	46.04	46.04	36.6	36.6	52.3	73.1
M30UMC-20R	30.0	1-1/4	26.0	46.04	49.21	39.6	39.2	55.6	77.2
M32UMC-20R	32.0	1-1/4	28.0	46.04	49.21	42.0	41.6	56.6	79.6
M38UMC-24R	38.0	1-1/2	33.0	55.56	60.32	49.4	47.9	64.0	91.6

Male NPT Threads are available for all metric UMC. Add "N" as a suffix instead of "R".



Male Elbow
UME

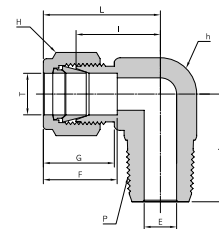

Connects Fractional Tube to Female NPT Thread

Part No.	Tube O.D. T		P (NPT)	E Min	h		H		F	G	l	L	L ₁
	in	mm			in	mm	in	mm					
20UME-20N	1-1/4	31.75	1-1/4	27	1-11/16	42.86	1-7/8	47.63	41.1	38.8	44.4	66.5	47.7
24UME-24N	1-1/2	38.10	1-1/2	34	2	50.80	2-1/4	57.15	50.0	45.2	50.8	77.9	60.4
32UME-32N	2	50.80	2	46	2-3/4	69.85	3	76.20	62.7	63.7	69.8	107.1	70.6

Male ISO Tapered Threads are available for all fractional UME. Add "R" as a suffix instead of "N".

Connects Metric Tube to Female ISO Tapered Thread

Part No.	Tube O.D. T(mm)	P (PT)	E Min	h (mm)	H (mm)	F	G	l	L	L ₁
M30UME-20R	30.00	1-1/4	26	46.04	49.21	39.6	39.2	48.3	69.9	53.1
M32UME-20R	32.00	1-1/4	27	46.04	49.21	42.0	41.6	49.3	72.3	53.1
M38UME-32R	38.00	1-1/2	33	55.56	60.32	49.4	47.9	56.4	84.0	60.4

Male NPT Threads are available for all metric UME. Add "N" as a suffix instead of "R".

Note : Dimensions are reference only, subject to change without prior notice. F,G and L are typical finger tight.