

Auto Welding Types • WCLE/WCLT/WCLRT

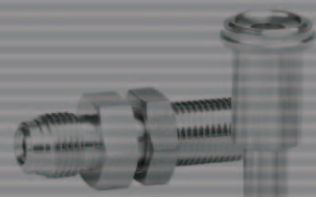

Long Elbow WCLE

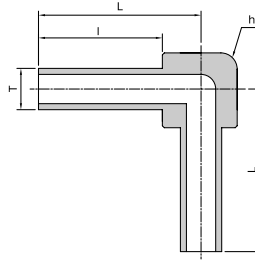

Part No.	T		Wall Thickness	l	h		L	Pressure Rating (psi)
	in	mm			in	mm		
WCLE-04	1/4	6.35	0.89	19.1	7/16	11.11	31.2	5100
WCLE-06	3/8	9.52	0.89	19.1	7/16	11.11	30.5	3300
WCLE-08	1/2	12.70	1.24	19.1	11/16	17.46	34.0	3700
WCLE-12	3/4	19.05	1.24	19.1	15/16	23.81	37.1	2400

Long Tee WCLT

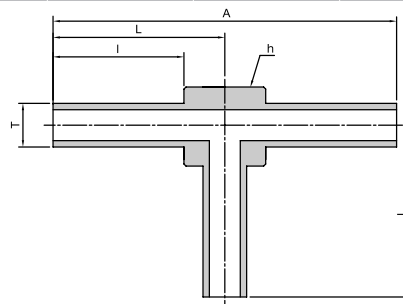

Part No.	T		Wall Thickness	A	l	h		L	Pressure Rating (psi)
	in	mm				in	mm		
WCLT-04	1/4	6.35	0.89	62.5	19.1	7/16	11.11	31.2	5100
WCLT-06	3/8	9.52	0.89	61.0	19.1	7/16	11.11	30.5	3300
WCLT-08	1/2	12.70	1.24	68.1	19.1	11/16	17.46	34.0	3700
WCLT-12	3/4	19.05	1.24	73.9	19.1	15/16	23.81	37.1	2400

Long Reducing Tee WCLRT

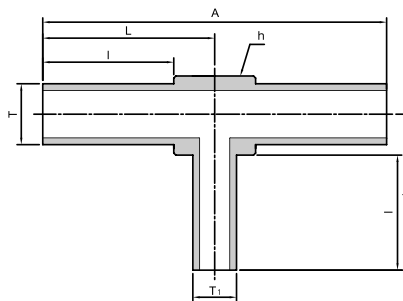

Part No.	T		Wall Thickness	T ₁		Wall Thickness	A	l	h		L	L ₁	Pressure Rating (psi)
	in	mm		in	mm				in	mm			
06WCLRT-04	3/8	9.52	0.89	1/4	6.35	0.89	60.7	19.1	7/16	11.11	30.5	31.2	3300
08WCLRT-04	1/2	12.70	1.24	1/4	6.35	0.89	67.8	19.1	11/16	17.46	34.0	34.0	3700
08WCLRT-06	1/2	12.70	1.24	3/8	9.52	0.89	67.8	19.1	11/16	17.46	34.0	34.3	3300
12WCLRT-06	3/4	19.05	1.24	3/8	9.52	0.89	73.9	19.1	15/16	23.81	37.1	34.3	2400
12WCLRT-04	3/4	19.05	1.24	1/4	6.35	0.89	73.9	19.1	15/16	23.81	37.1	37.6	2400

Note : Dimensions are reference only, subject to change without prior notice. F, G and L are typical finger tight.



유니온금속공업(주)
UNION METAL INDUSTRIAL CO.,LTD.

본사 및 공장
인천광역시 남동구 고잔동 704번지
남동공단 133블럭 1롯데
TEL : (032)821-6601(대) FAX:(032)821-6604
http://www.unilok.com
E-mail : unilok@unilok.com
서울직매장
서울특별시 구로구 구로동 604-1
구로기계공구상가 D-31-110호
TEL : (02)2676-6673(대) FAX:(02)2679-6673

Head Office and Factory
133 Block-1Lot, Namdong Industrial Complex,
704, Gojan-Dong, Namdong-Gu, Incheon, KOREA.
TEL : +82-32-821-6601 FAX : +82-32-821-6604
http://www.unilok.com
E-mail : unilok@unilok.com
Seoul Office
D-31-110, Guro Tools Center.
604-1, Guro-Dong, Guro-Gu, Seoul, KOREA.
TEL : +82-2-2676-6673 FAX : +82-2-2679-6673